

ADDENDUM # 1
Fayetteville Road Water Main Improvements
City of Fairburn

Bids Due: December 22, 2020 at 2:00 p.m.
ISE Project #: 1009.2001

Date: December 17, 2020

***PLEASE MAKE THE FOLLOWING CHANGES TO THE CONTRACT DOCUMENTS.
ALL DOCUMENTS ATTACHED:***

1. Question: *“Do you have a construction cost/estimated budget?”*

Answer: Not available at this time.

2. Question: *“Can I get a copy of the pre-bid sign in sheet or updated plan holders list?”*

Answer: The pre-bid sign in sheet and updated plan holders list are located on our website, www.intse.com. Click on Bid Documents in the top right corner, complete necessary information to get access to our sharefile site.

3. Question: *“Was this bid posted to the nationwide free bid notification website at www.mygovwatch.com/free?”*

Answer: No.

4. Question: *“Other than your own website, where was this bid posted?”*

Answer: City of Fairburn’s website, www.fairburn.com
Georgia Procurement Registry, <http://ssl.doas.state.ga.us/PRAapp/>

5. Question: *“Do you anticipate extending the bid due date?”*

Answer: No.

6. Question: *“What additional details are you willing to provide, if any, beyond what is stated in bid documents concerning how you will identify the winning bid?”*

Answer: Please read specification section 00 21 13 “Instructions to Bidders”

7. Question: *“The drawings indicate a trench width of 10 feet. Is it acceptable to make the trench width 4 feet wide? If not, can the trench width be shortened to allow for steel plates to be used in the typical direction?”*

Answer: Trench Width shall be no greater than 5 feet. There is no minimum.

8. Question: *“Can work zone remain closed over night or only when work is in progress?”*

Answer: Yes, as long as driveway access is maintained and proper signage is used.

9. Question: *"The trench detail requires 57 stone bedding and shows select fill above the pipe. Can the native dirt be used for backfill if it passes compaction requirements?"*

Answer: See revised trench detail for bedding on sheet C-700. Yes, native dirt can be used if it passes compaction requirements.

10. Question: *"Can we come back with GAB instead of trench cap due to weather and icing?"*

Answer: See revised trench cap detail on sheet C-702.

11. Question: *"Do you know the thickness of the asphalt on the roadway area?"*

Answer: No.

12. Question: *"Can we get a poundage for fittings where the 8" crosses existing lines?"*

Answer: Payment for fittings will not be based on poundage.

13. Question: *"Where can we store the materials/equipment?"*

Answer: Materials/equipment can be stored in ROW with proper signage. During construction police will patrol Fayetteville Road.

14. Question: *Will contractor be required to have a builders risk and OCP policy?*

Answer: Yes, contractor awarded the job shall have both policies as outlined in the supplemental conditions section S.C.-5.05 and S.C.-5.06.

15. See revised notes 3 and 4 on sheets C-101 through C-105.

16. See revised erosion control (SD2-P) on sheets C-101 through C-103. Item 21 on Bid Form shall also be changed to SD2-P.

END OF ADDENDUM NO. 1

- NOTES:**
1. NEW WATER SERVICE LINES MAY BE INSTALLED BY OPEN EXCAVATION WHERE POSSIBLE IN UN-PAVED AREAS OR OTHERWISE BY HDD. CUT AND CAP EXISTING SERVICE LINES TO BE ABANDONED, AND PROVIDE ADEQUATE SPACING AWAY FROM METERS TO PERMIT CONNECTIONS OF NEW SERVICE LINES.
 2. PROVIDE JOINT DEFLECTIONS AND/OR FITTINGS AS NECESSARY TO INSTALL NEW WATER MAIN BELOW EX SIDE ROAD WATER MAINS WHERE THEY CROSS. IT IS INTENDED FOR NEW FIRE HYDRANTS TO BE INSTALLED. GAIN ENGINEER'S APPROVAL FOR ALTERNATE PLAN INVOLVING HYDRANT RELOCATION.
 3. IT IS INTENDED FOR NEW FIRE HYDRANTS TO BE INSTALLED. GAIN ENGINEER'S APPROVAL FOR ALTERNATE PLAN INVOLVING HYDRANT RELOCATION.
 4. INSTALL STANDARD TERMINATION ON EX HYDRANT SUPPLY PIPE TO BE DISCONNECTED AND EX HYDRANTS TO BE RETURNED TO THE CITY.

1 REVISED NOTE 3
1 REVISED NOTE 4

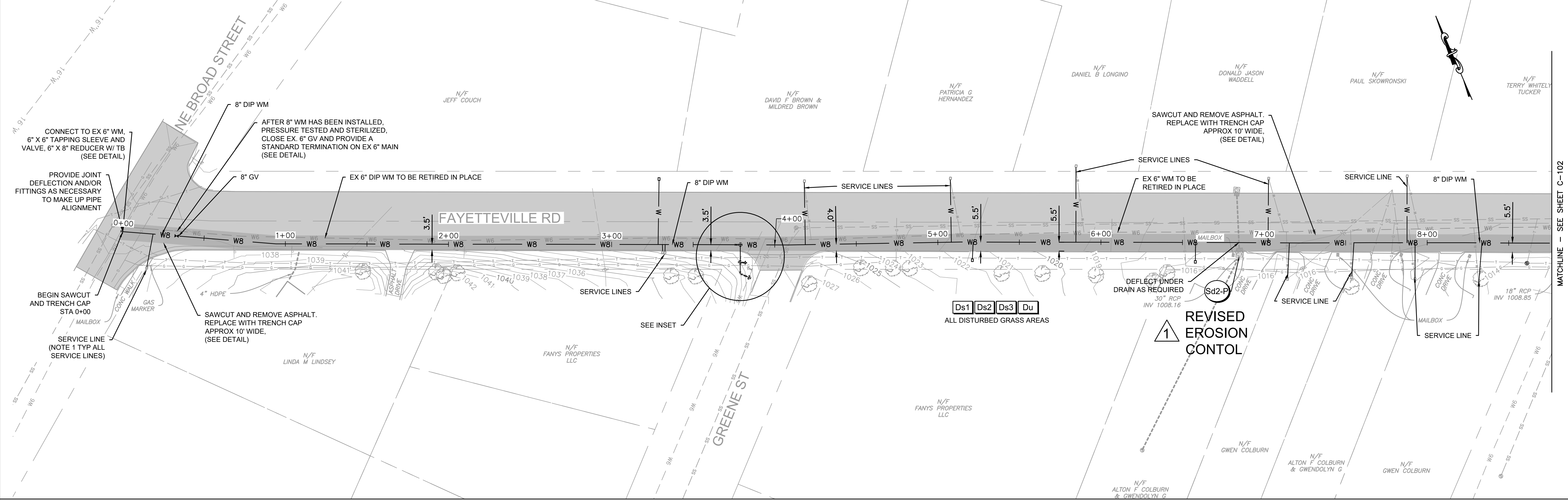

INTEGRATED Science & Engineering
1038 SULLY ROAD, SUITE 200, NEWNAN, GEORGIA 30065
(770) 785-5522 / 106 (P) 785-5522 / 107
COA #: PE000623 Exp. 6/30/2022

REGISTERED PROFESSIONAL ENGINEER
CARY R. DILL

DATE: 11/12/20
DRAWN BY: JMN
CHECK BY: VIZ
PROJECT #: 1009.1509
DESIGN BY: JMJ
REVIEW BY: CRD

SCALE: 1" = 30'

REVISIONS:

Rev.	Description	Date
1	ADDENDUM NO. 1	12/17

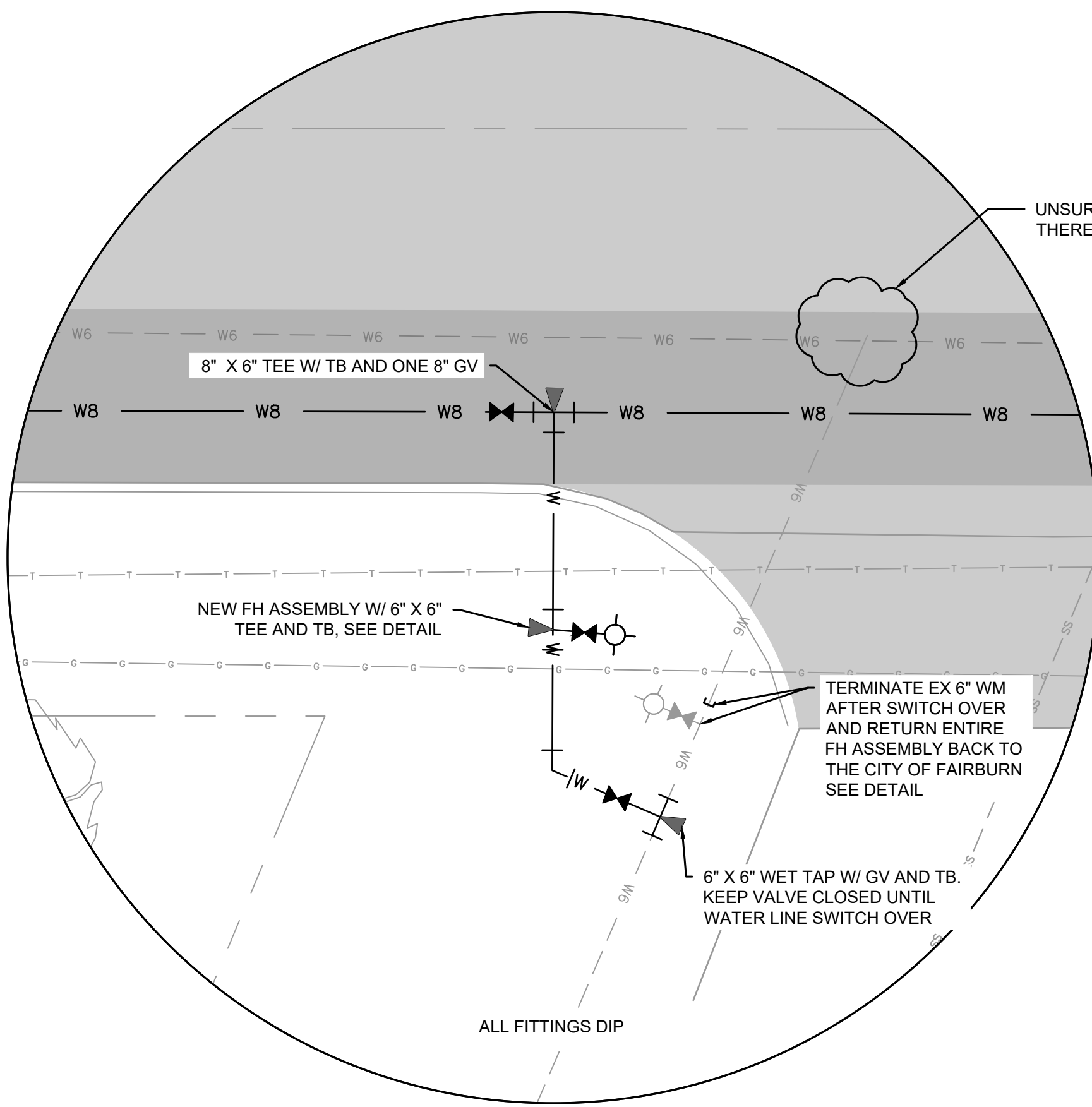

**PHASE I
STRUCTURAL PRACTICES**
THERE ARE NO STRUCTURAL PRACTICES FOR PHASE I

VEGETATIVE PRACTICES
THERE ARE NO VEGETATIVE PRACTICES FOR PHASE I

EROSION, SEDIMENTATION AND POLLUTION CONTROL NOTES:

1. 24-HOUR CONTACT: JOHN MARTIN (770) 964-2244
2. DISTURBED AREA: 1.06 ACRES; TOTAL SITE AREA: 1.06 ACRES
3. THE ESCAPE OF SEDIMENT FROM THE SITE SHALL BE PREVENTED BY THE INSTALLATION OF EROSION AND SEDIMENT CONTROL MEASURES AND PRACTICES PRIOR TO LAND DISTURBING ACTIVITIES.
4. EROSION CONTROL MEASURES WILL BE MAINTAINED AT ALL TIMES. IF FULL IMPLEMENTATION OF THE APPROVED PLAN DOES NOT PROVIDE FOR EFFECTIVE EROSION CONTROL, ADDITIONAL EROSION AND SEDIMENT CONTROL MEASURES SHALL BE IMPLEMENTED TO CONTROL OR TREAT THE SEDIMENT SOURCE.
5. ALL EROSION CONTROL MEASURES ARE TO CONFORM TO THE STANDARDS SET FORTH IN THE "MANUAL FOR EROSION AND SEDIMENT CONTROL IN GEORGIA" LATEST EDITION.
6. ANY DISTURBED AREA LEFT EXPOSED FOR A PERIOD GREATER THAN 14 DAYS SHALL BE STABILIZED WITH MULCH OR TEMPORARY SEEDING.
7. SEDIMENT CONTROL MEASURES MUST BE INSTALLED BEFORE CLEARING AND GRADING BEGINS.

**PHASE II
STRUCTURAL PRACTICES**

CODE	PRACTICE	DETAIL	MAP SYMBOL	DESCRIPTION
Sd2	INLET SEDIMENT TRAP			A temporary protective device formed at or around an inlet to a storm drain to trap sediment.

VEGETATIVE PRACTICES

CODE	PRACTICE	DETAIL	MAP SYMBOL	DESCRIPTION
Du	DUST CONTROL ON DISTURBED AREAS			Controlling surface and air movement of dust on construction site, roadways and similar sites.
Ds1	DISTURBED AREA STABILIZATION (WITH MULCHING ONLY)			Establishing temporary protection for disturbed areas where seedlings may not have a suitable growing season to produce an erosion retarding cover.
Ds2	DISTURBED AREA STABILIZATION (WITH TEMP SEEDING)			Establishing a temporary vegetative cover with fast growing seedlings on disturbed areas.

**PHASE III
STRUCTURAL PRACTICES**
THERE ARE NO STRUCTURAL PRACTICES FOR PHASE III

VEGETATIVE PRACTICES

CODE	PRACTICE	DETAIL	MAP SYMBOL	DESCRIPTION
Ds3	DISTURBED AREA STABILIZATION (WITH PERM SEEDING)			Establishing a permanent vegetative cover such as trees, shrubs, vines, grasses, or legumes on disturbed areas.

UTILITY PLANS FOR
FAYETTEVILLE ROAD
WATER MAIN IMPROVEMENTS
CITY OF FAIRBURN
PROJECT LOCATED IN LAND LOT 52 AND 53 OF THE 9F DISTRICT, FULTON COUNTY, GEORGIA

SITE PLAN 1
STA. 00+00 - STA. 08+75

DRAWING NO.
C-101

- NOTES:**
- NEW WATER SERVICE LINES MAY BE INSTALLED BY OPEN EXCAVATION WHERE POSSIBLE IN UN-PAVED AREAS OR OTHERWISE BY HDD. CUT AND CAP EXISTING SERVICE LINES TO BE ABANDONED, AND PROVIDE ADEQUATE SPACING AWAY FROM METERS TO PERMIT CONNECTIONS OF NEW SERVICE LINES.
 - PROVIDE JOINT DEFLECTIONS AND/OR FITTINGS AS NECESSARY TO INSTALL NEW WATER MAIN BELOW EX SIDE ROAD WATER MAINS WHERE THEY CROSS.
 - IT IS INTENDED FOR NEW FIRE HYDRANTS TO BE INSTALLED. GAIN ENGINEER'S APPROVAL FOR ALTERNATE PLAN INVOLVING HYDRANT RELOCATION.
 - INSTALL STANDARD TERMINATION ON EX HYDRANT SUPPLY PIPE TO BE DISCONNECTED AND EX HYDRANTS TO BE RETURNED TO THE CITY.

1 REVISED NOTE 3
1 REVISED NOTE 4

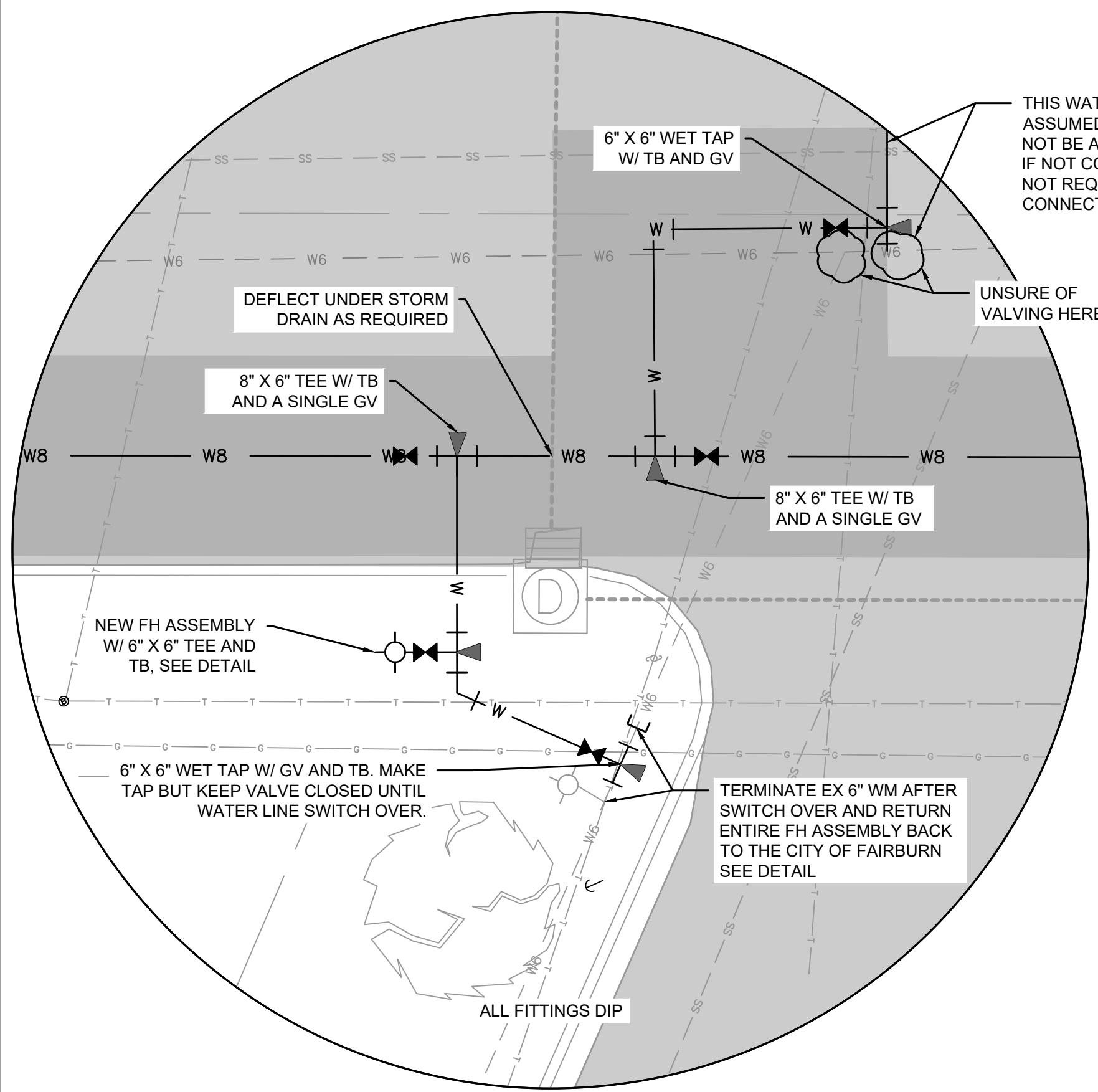
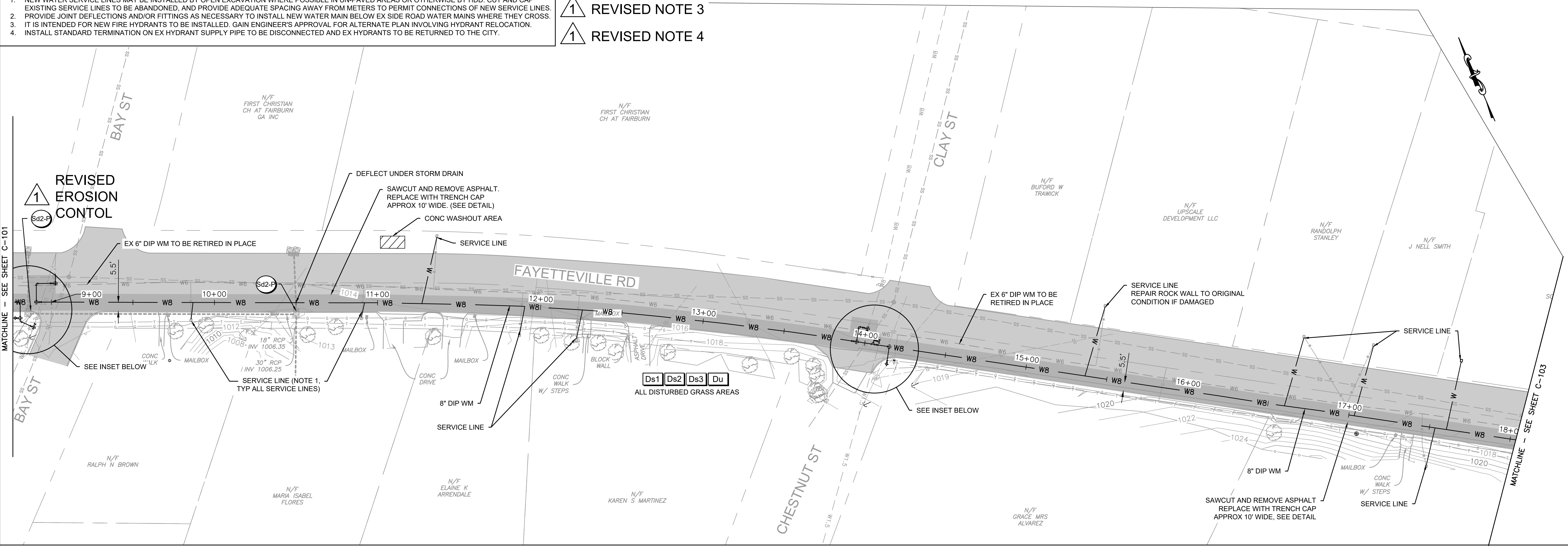

BAY STREET
SCALE: 1" = 6'

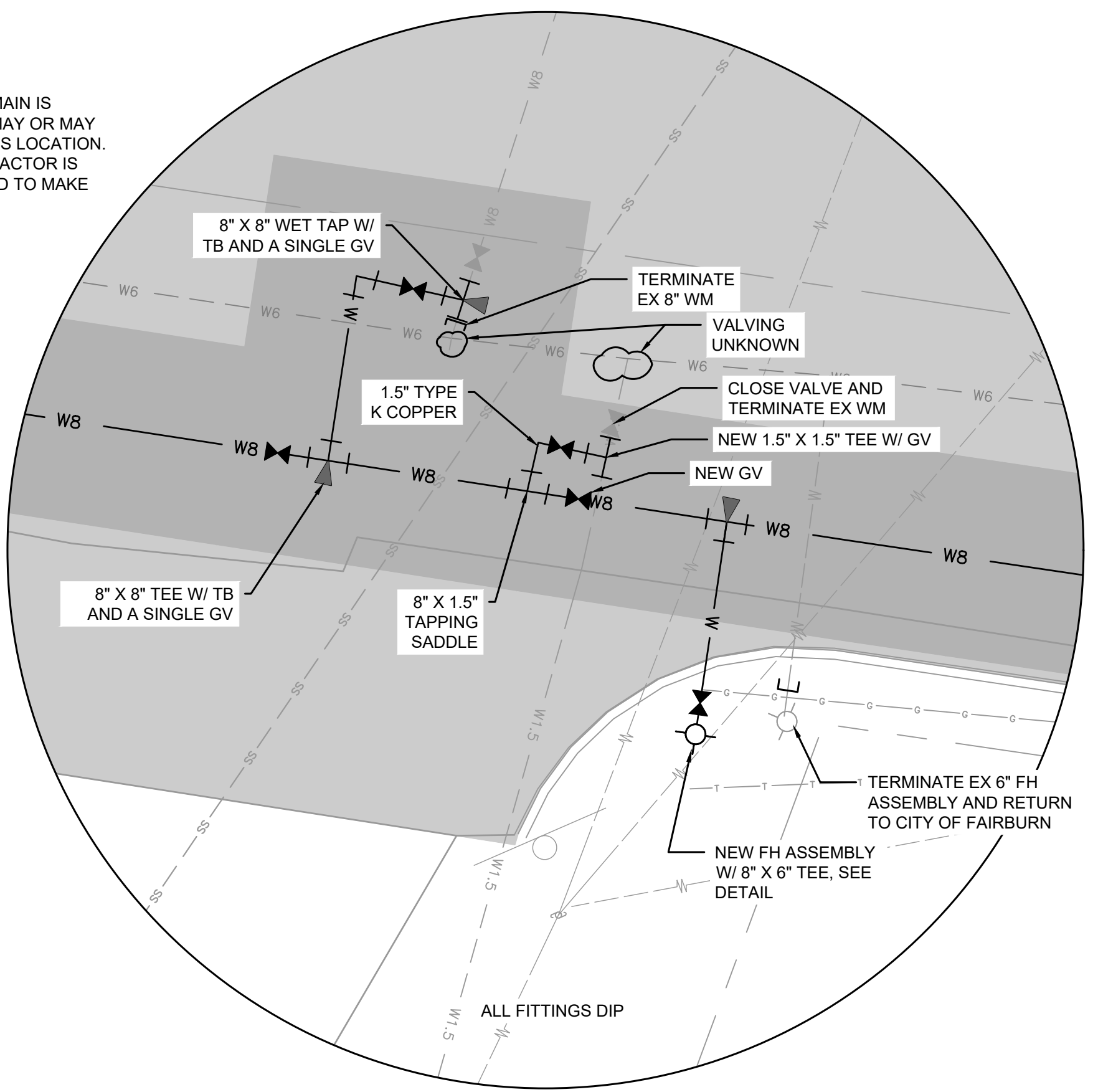

CLAY AND CHESTNUT
SCALE: 1" = 6'

**PHASE I
STRUCTURAL PRACTICES**
THERE ARE NO STRUCTURAL PRACTICES FOR PHASE I

VEGETATIVE PRACTICES
THERE ARE NO VEGETATIVE PRACTICES FOR PHASE I

EROSION, SEDIMENTATION AND POLLUTION CONTROL NOTES:

- 24-HOUR CONTACT: JOHN MARTIN (770) 964-2244
- DISTURBED AREA: 1.06 ACRES; TOTAL SITE AREA: 1.06 ACRES
- THE ESCAPE OF SEDIMENT FROM THE SITE SHALL BE PREVENTED BY THE INSTALLATION OF EROSION AND SEDIMENT CONTROL MEASURES AND PRACTICES PRIOR TO LAND DISTURBING ACTIVITIES.
- EROSION CONTROL MEASURES WILL BE MAINTAINED AT ALL TIMES. IF FULL IMPLEMENTATION OF THE APPROVED PLAN DOES NOT PROVIDE FOR EFFECTIVE EROSION CONTROL, ADDITIONAL EROSION AND SEDIMENT CONTROL MEASURES SHALL BE IMPLEMENTED TO CONTROL OR TREAT THE SEDIMENT SOURCE.
- ALL EROSION CONTROL MEASURES ARE TO CONFORM TO THE STANDARDS SET FORTH IN THE "MANUAL FOR EROSION AND SEDIMENT CONTROL IN GEORGIA" LATEST EDITION.
- ANY DISTURBED AREA LEFT EXPOSED FOR A PERIOD GREATER THAN 14 DAYS SHALL BE STABILIZED WITH MULCH OR TEMPORARY SEEDING.
- SEDIMENT CONTROL MEASURES MUST BE INSTALLED BEFORE CLEARING AND GRADING BEGINS.

**PHASE II
STRUCTURAL PRACTICES**

CODE	PRACTICE	DETAIL	MAP SYMBOL	DESCRIPTION
Sd2	INLET SEDIMENT TRAP			A temporary protective device formed at or around an inlet to a storm drain to trap sediment.

VEGETATIVE PRACTICES

CODE	PRACTICE	DETAIL	MAP SYMBOL	DESCRIPTION
Du	DUST CONTROL ON DISTURBED AREAS			Controlling surface and air movement of dust on construction site, roadways and similar sites.
Ds1	DISTURBED AREA STABILIZATION (WITH MULCHING ONLY)			Establishing temporary protection for disturbed areas where seedlings may not have a suitable growing season to produce an erosion retarding cover.
Ds2	DISTURBED AREA STABILIZATION (WITH TEMP SEEDING)			Establishing a temporary vegetative cover with fast growing seedlings on disturbed areas.

**PHASE III
STRUCTURAL PRACTICES**

THERE ARE NO STRUCTURAL PRACTICES FOR PHASE III

VEGETATIVE PRACTICES

CODE	PRACTICE	DETAIL	MAP SYMBOL	DESCRIPTION
Ds3	DISTURBED AREA STABILIZATION (WITH PERM SEEDING)			Establishing a permanent vegetative cover such as trees, shrubs, vines, grasses, or legumes on disturbed areas.

Drawn By:	Check By:	Date:
JMN	VIZ	
Design By:	Review By:	
JMO	CRD	
Project #:	1005-1509	
Scale:	1" = 30'	
Revised:		
1	ADDITIONAL NO. 1	12/17
	Description	Apr

- NOTES:
- NEW WATER SERVICE LINES MAY BE INSTALLED BY OPEN EXCAVATION WHERE POSSIBLE IN UN-PAVED AREAS OR OTHERWISE BY HDD. CUT AND CAP EXISTING SERVICE LINES TO BE ABANDONED, AND PROVIDE ADEQUATE SPACING AWAY FROM METERS TO PERMIT CONNECTIONS OF NEW SERVICE LINES.
 - PROVIDE JOINT DEFLECTIONS AND/OR FITTINGS AS NECESSARY TO INSTALL NEW WATER MAIN BELOW EX SIDE ROAD WATER MAINS WHERE THEY CROSS.
 - IT IS INTENDED FOR NEW FIRE HYDRANTS TO BE INSTALLED. GAIN ENGINEER'S APPROVAL FOR ALTERNATE PLAN INVOLVING HYDRANT RELOCATION.
 - INSTALL STANDARD TERMINATION ON EX HYDRANT SUPPLY PIPE TO BE DISCONNECTED AND EX HYDRANTS TO BE RETURNED TO THE CITY.

1 REVISED NOTE 3
1 REVISED NOTE 4

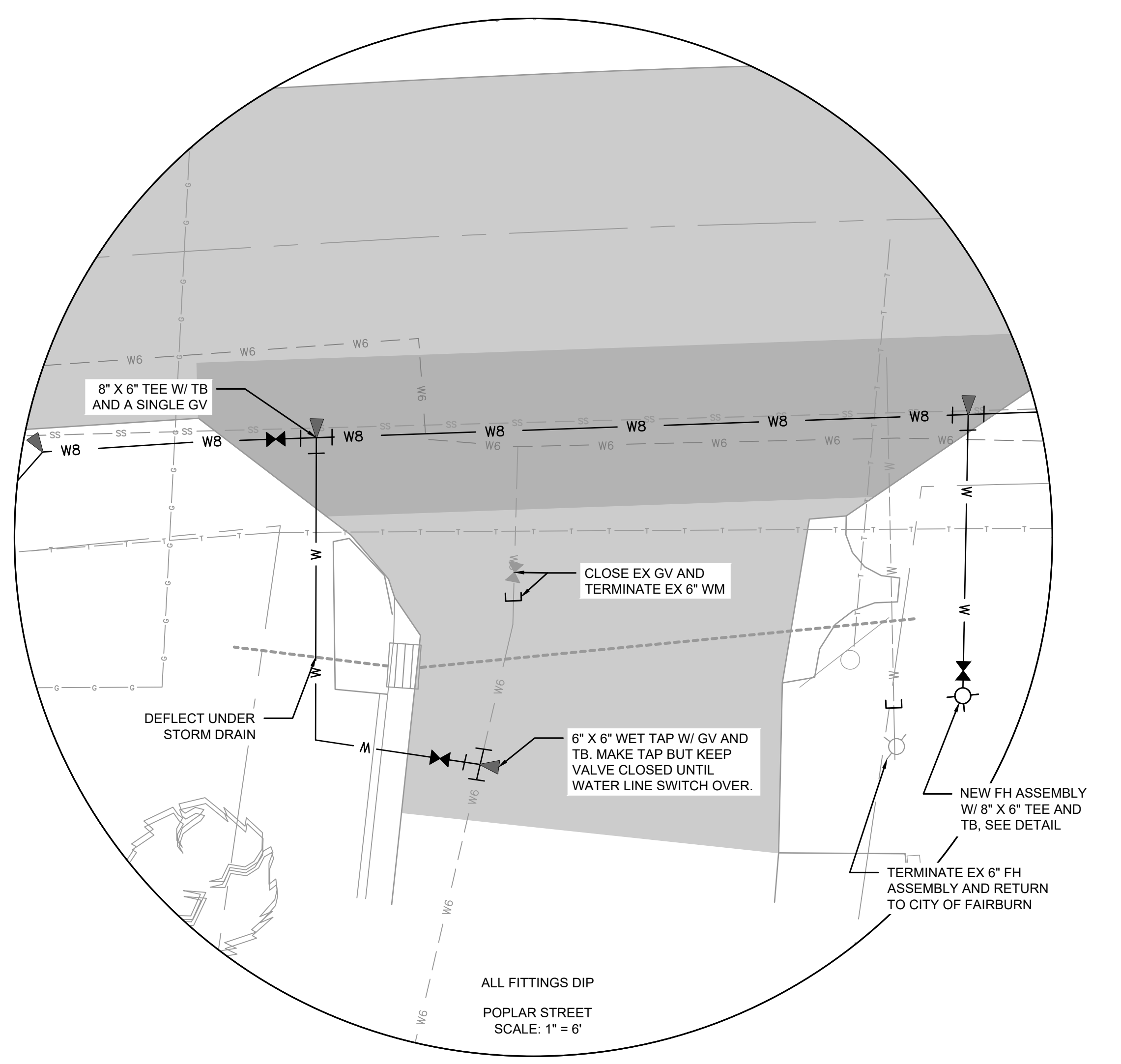
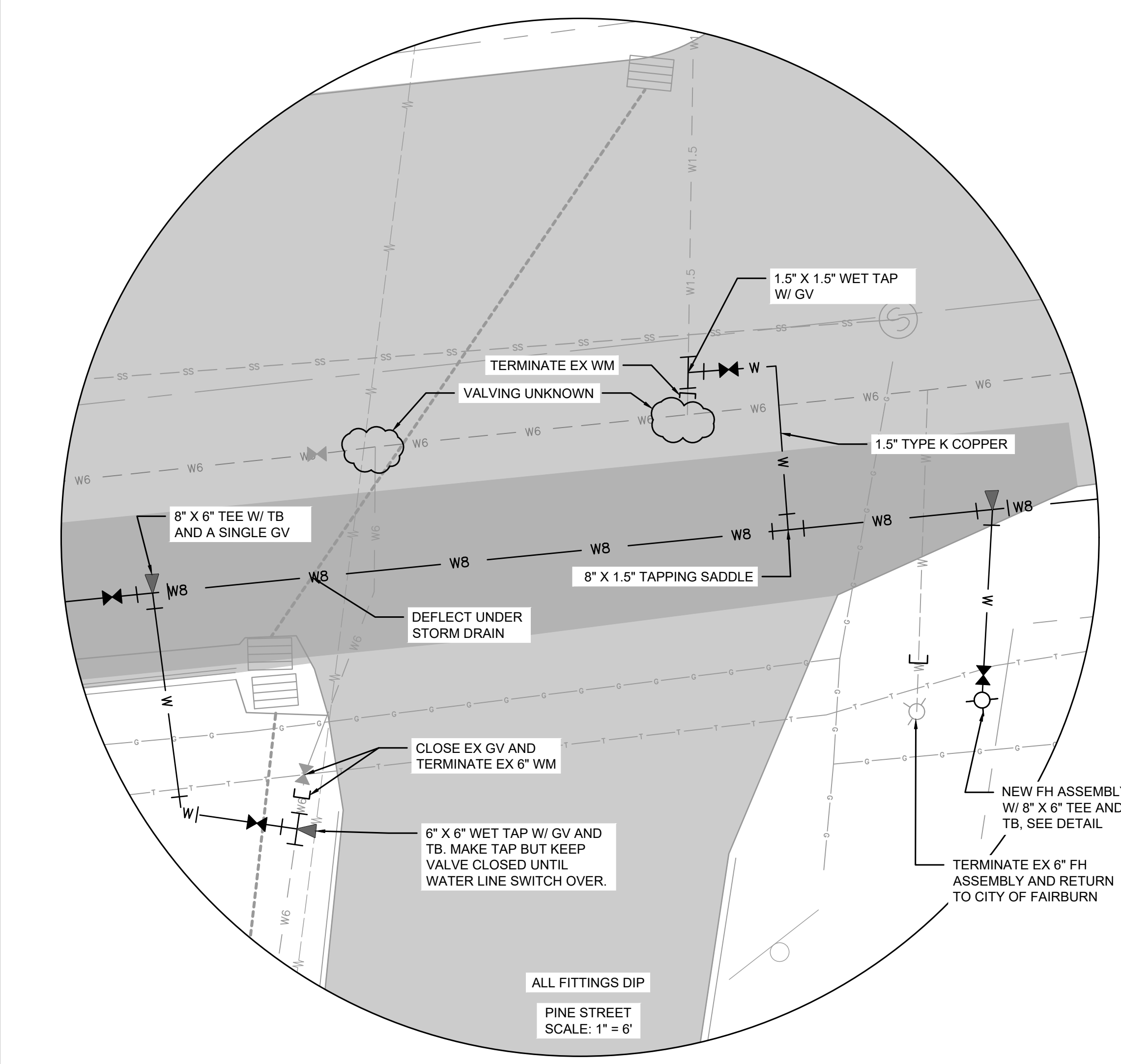
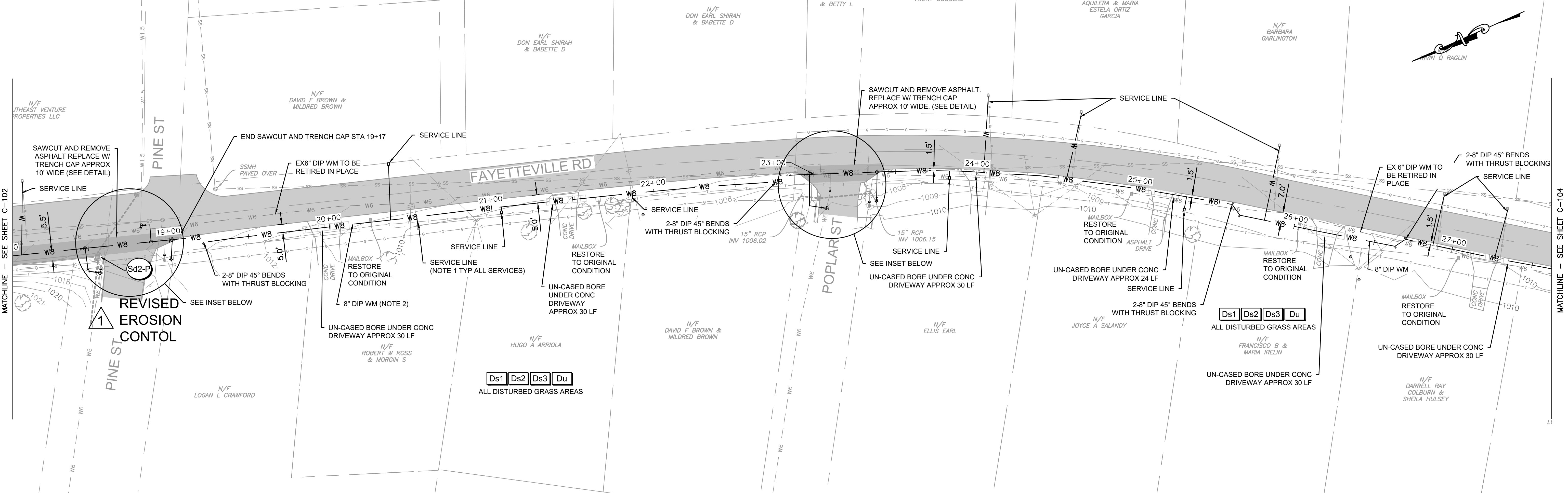

PHASE I
STRUCTURAL PRACTICES
THERE ARE NO STRUCTURAL PRACTICES FOR PHASE I

VEGETATIVE PRACTICES
THERE ARE NO VEGETATIVE PRACTICES FOR PHASE I

PHASE II
STRUCTURAL PRACTICES

CODE	PRACTICE	DETAIL	MAP SYMBOL	DESCRIPTION
Sd2	INLET SEDIMENT TRAP			A temporary protective device formed at or around an inlet to a storm drain to trap sediment.

VEGETATIVE PRACTICES

CODE	PRACTICE	DETAIL	MAP SYMBOL	DESCRIPTION
Du	DUST CONTROL ON DISTURBED AREAS			Controlling surface and air movement of dust on construction site, roadways and similar sites.
Ds1	DISTURBED AREA STABILIZATION (WITH MULCHING ONLY)			Establishing temporary protection for disturbed areas where seedlings may not have a suitable growing season to produce an erosion retarding cover.
Ds2	DISTURBED AREA STABILIZATION (WITH TEMP SEEDING)			Establishing a temporary vegetative cover with fast growing seedlings on disturbed areas.

PHASE III
STRUCTURAL PRACTICES
THERE ARE NO STRUCTURAL PRACTICES FOR PHASE III

VEGETATIVE PRACTICES

CODE	PRACTICE	DETAIL	MAP SYMBOL	DESCRIPTION
Ds3	DISTURBED AREA STABILIZATION (WITH PERM SEEDING)			Establishing a permanent vegetative cover such as trees, shrubs, vines, grasses, or legumes on disturbed areas.

INTEGRATED Science & Engineering
1039 SULLY ROAD, SUITE 200, NEWNAN, GEORGIA 30065
(770) 785-5222 / (770) 785-5222 / 107
COA #: PEFC00623 Exp. 6/30/2022

REGISTERED PROFESSIONAL ENGINEER
CARY R. DILL

Drawn By: JMN	Check By: VIZ	Date: Apr
Project #: 1009-1509	Design By: JMN	Review By: CRD
Scale: 1" = 30'	30' 15' 0'	12/17
1	ADDENDUM NO. 1	Date
1	ADDENDUM NO. 1	Date

UTILITY PLANS FOR
FAYETTEVILLE ROAD
WATER MAIN IMPROVEMENTS
CITY OF FAIRBURN
PROJECT LOCATED IN LAND LOT 52 AND 53 OF THE 9TH DISTRICT, FULTON COUNTY, GEORGIA

SITE PLAN 3
STA. 18+03 - STA. 27+62

DRAWING NO.
C-103

- NOTES:**
1. NEW WATER SERVICE LINES MAY BE INSTALLED BY OPEN EXCAVATION WHERE POSSIBLE IN UN-PAVED AREAS OR OTHERWISE BY HDD. CUT AND CAP EXISTING SERVICE LINES TO BE ABANDONED, AND PROVIDE ADEQUATE SPACING AWAY FROM METERS TO PERMIT CONNECTIONS OF NEW SERVICE LINES.
 2. PROVIDE JOINT DEFLECTIONS AND/OR FITTINGS AS NECESSARY TO INSTALL NEW WATER MAIN BELOW EX SIDE ROAD WATER MAINS WHERE THEY CROSS.
 3. IT IS INTENDED FOR NEW FIRE HYDRANTS TO BE INSTALLED. GAIN ENGINEER'S APPROVAL FOR ALTERNATE PLAN INVOLVING HYDRANT RELOCATION.
 4. INSTALL STANDARD TERMINATION ON EX HYDRANT SUPPLY PIPE TO BE DISCONNECTED AND EX HYDRANTS TO BE RETURNED TO THE CITY.

1 REVISED NOTE 3
1 REVISED NOTE 4

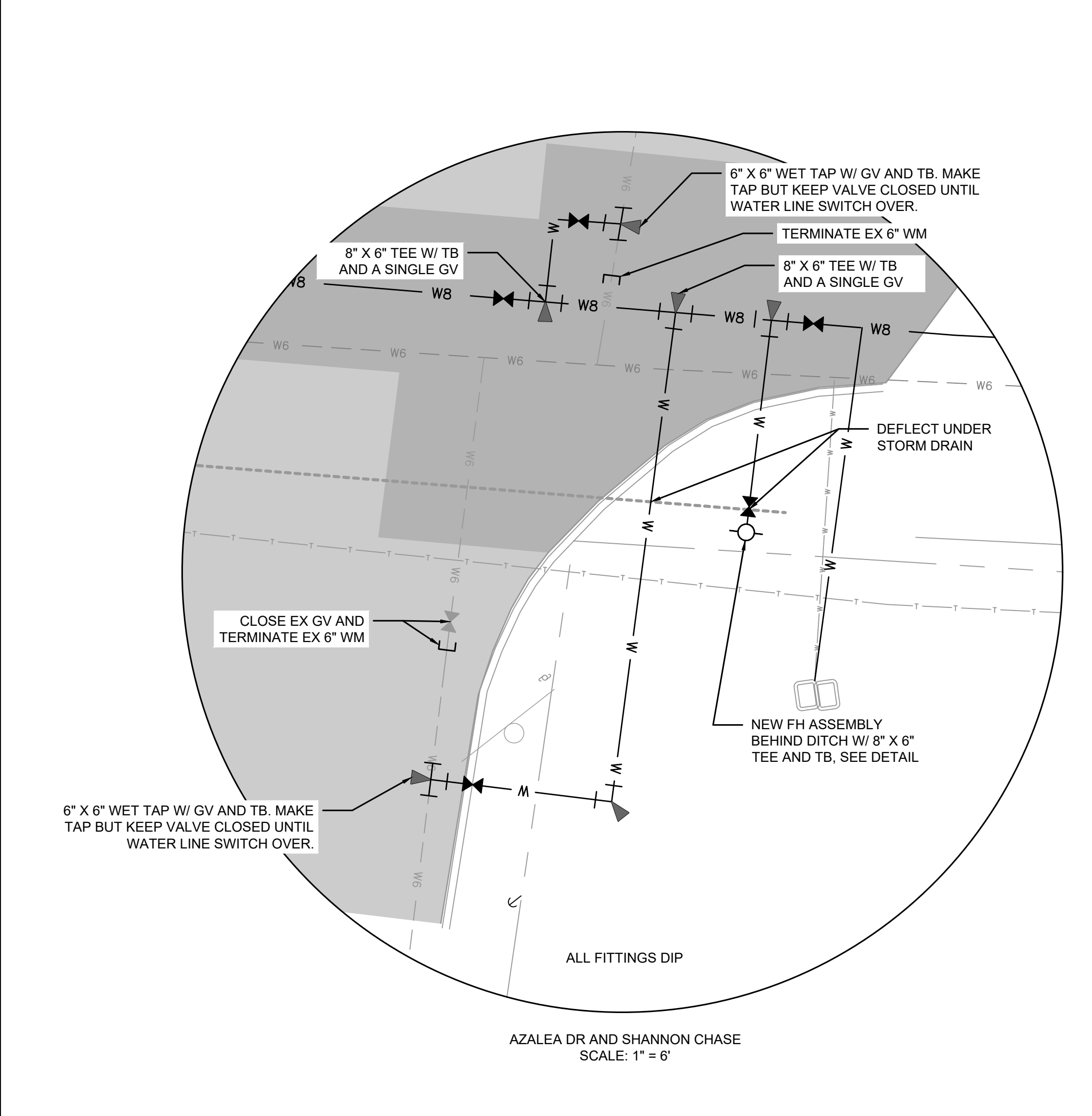
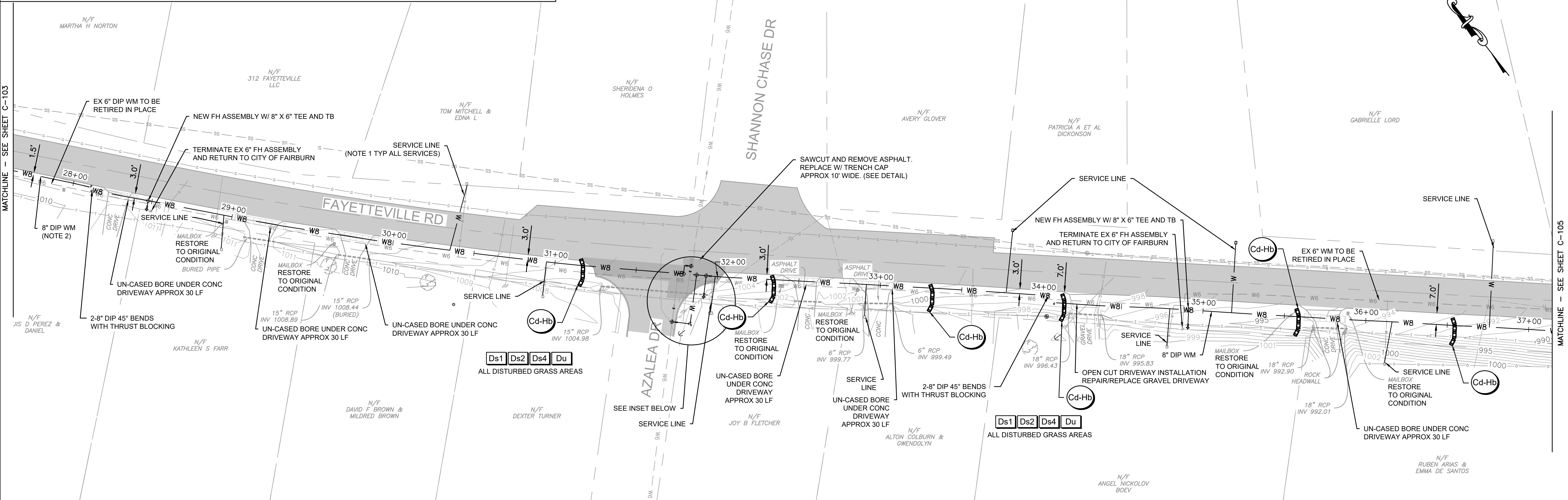

**PHASE I
STRUCTURAL PRACTICES**
THERE ARE NO STRUCTURAL PRACTICES FOR PHASE I

VEGETATIVE PRACTICES
THERE ARE NO VEGETATIVE PRACTICES FOR PHASE I

EROSION, SEDIMENTATION AND POLLUTION CONTROL NOTES:

1. 24-HOUR CONTACT: JOHN MARTIN (770) 964-2244
2. DISTURBED AREA: 1.06 ACRES; TOTAL SITE AREA: 1.06 ACRES
3. THE ESCAPE OF SEDIMENT FROM THE SITE SHALL BE PREVENTED BY THE INSTALLATION OF EROSION AND SEDIMENT CONTROL MEASURES AND PRACTICES PRIOR TO LAND DISTURBING ACTIVITIES.
4. EROSION CONTROL MEASURES WILL BE MAINTAINED AT ALL TIMES. IF FULL IMPLEMENTATION OF THE APPROVED PLAN DOES NOT PROVIDE FOR EFFECTIVE EROSION CONTROL, ADDITIONAL EROSION AND SEDIMENT CONTROL MEASURES SHALL BE IMPLEMENTED TO CONTROL OR TREAT THE SEDIMENT SOURCE.
5. ALL EROSION CONTROL MEASURES ARE TO CONFORM TO THE STANDARDS SET FORTH IN THE "MANUAL FOR EROSION AND SEDIMENT CONTROL IN GEORGIA" LATEST EDITION.
6. ANY DISTURBED AREA LEFT EXPOSED FOR A PERIOD GREATER THAN 14 DAYS SHALL BE STABILIZED WITH MULCH OR TEMPORARY SEEDING.
7. SEDIMENT CONTROL MEASURES MUST BE INSTALLED BEFORE CLEARING AND GRADING BEGINS.

**PHASE II
STRUCTURAL PRACTICES**

CODE	PRACTICE	DETAIL	MAP SYMBOL	DESCRIPTION
Cd	CHECKDAM			A small temporary barrier or dam constructed across a swale, drainage ditch or area of concentrated flow.

VEGETATIVE PRACTICES

CODE	PRACTICE	DETAIL	MAP SYMBOL	DESCRIPTION
Du	DUST CONTROL ON DISTURBED AREAS			Controlling surface and air movement of dust on construction site, roadways and similar sites.
Ds1	DISTURBED AREA STABILIZATION (WITH MULCHING ONLY)			Establishing temporary protection for disturbed areas where seedlings may not have a suitable growing season to produce an erosion retarding cover.
Ds2	DISTURBED AREA STABILIZATION (WITH TEMP SEEDING)			Establishing a temporary vegetative cover with fast growing seedlings on disturbed areas.

**PHASE III
STRUCTURAL PRACTICES**

THERE ARE NO STRUCTURAL PRACTICES FOR PHASE III

VEGETATIVE PRACTICES

CODE	PRACTICE	DETAIL	MAP SYMBOL	DESCRIPTION
Ds3	DISTURBED AREA STABILIZATION (WITH PERM SEEDING)			Establishing a permanent vegetative cover such as trees, shrubs, vines, grasses, or legumes on disturbed areas.



Drawn By:	Check By:	Date:
JMN	VZT	11/12/20
Design By:	Review By:	Date:
JMS	CRD	10/05/15(09)

1 ADDENDUM NO. 1
Date: 12/17
Rev. Description

- NOTES:**
- NEW WATER SERVICE LINES MAY BE INSTALLED BY OPEN EXCAVATION WHERE POSSIBLE IN UN-PAVED AREAS OR OTHERWISE BY HDD. CUT AND CAP EXISTING SERVICE LINES TO BE ABANDONED, AND PROVIDE ADEQUATE SPACING AWAY FROM METERS TO PERMIT CONNECTIONS OF NEW SERVICE LINES.
 - PROVIDE JOINT DEFLECTIONS AND/OR FITTINGS AS NECESSARY TO INSTALL NEW WATER MAIN BELOW EX SIDE ROAD WATER MAINS WHERE THEY CROSS. IT IS INTENDED FOR NEW FIRE HYDRANTS TO BE INSTALLED. GAIN ENGINEER'S APPROVAL FOR ALTERNATE PLAN INVOLVING HYDRANT RELOCATION.
 - INSTALL STANDARD TERMINATION ON EX HYDRANT SUPPLY PIPE TO BE DISCONNECTED AND EX HYDRANTS TO BE RETURNED TO THE CITY.

1 REVISED NOTE 3
1 REVISED NOTE 4

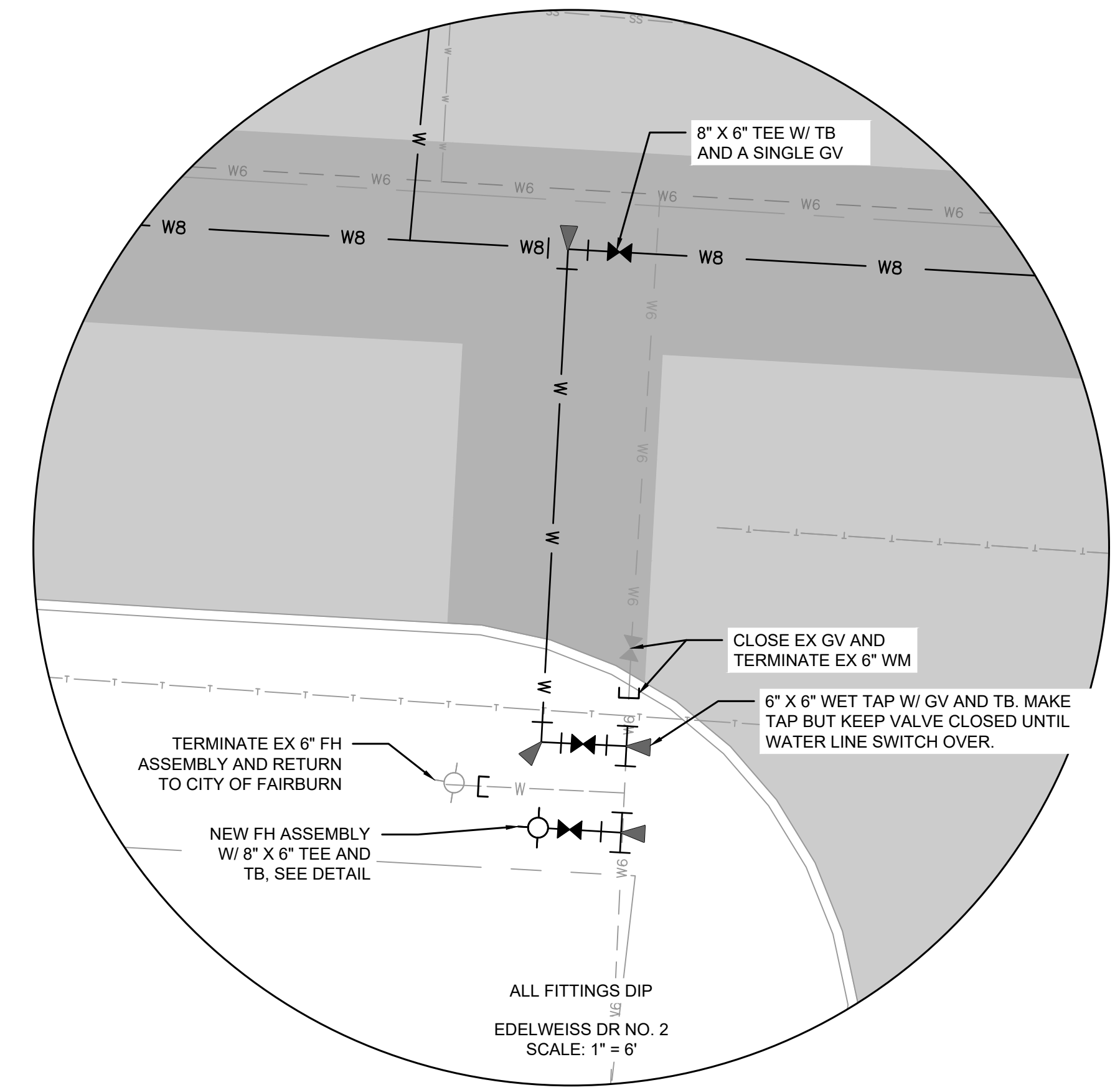
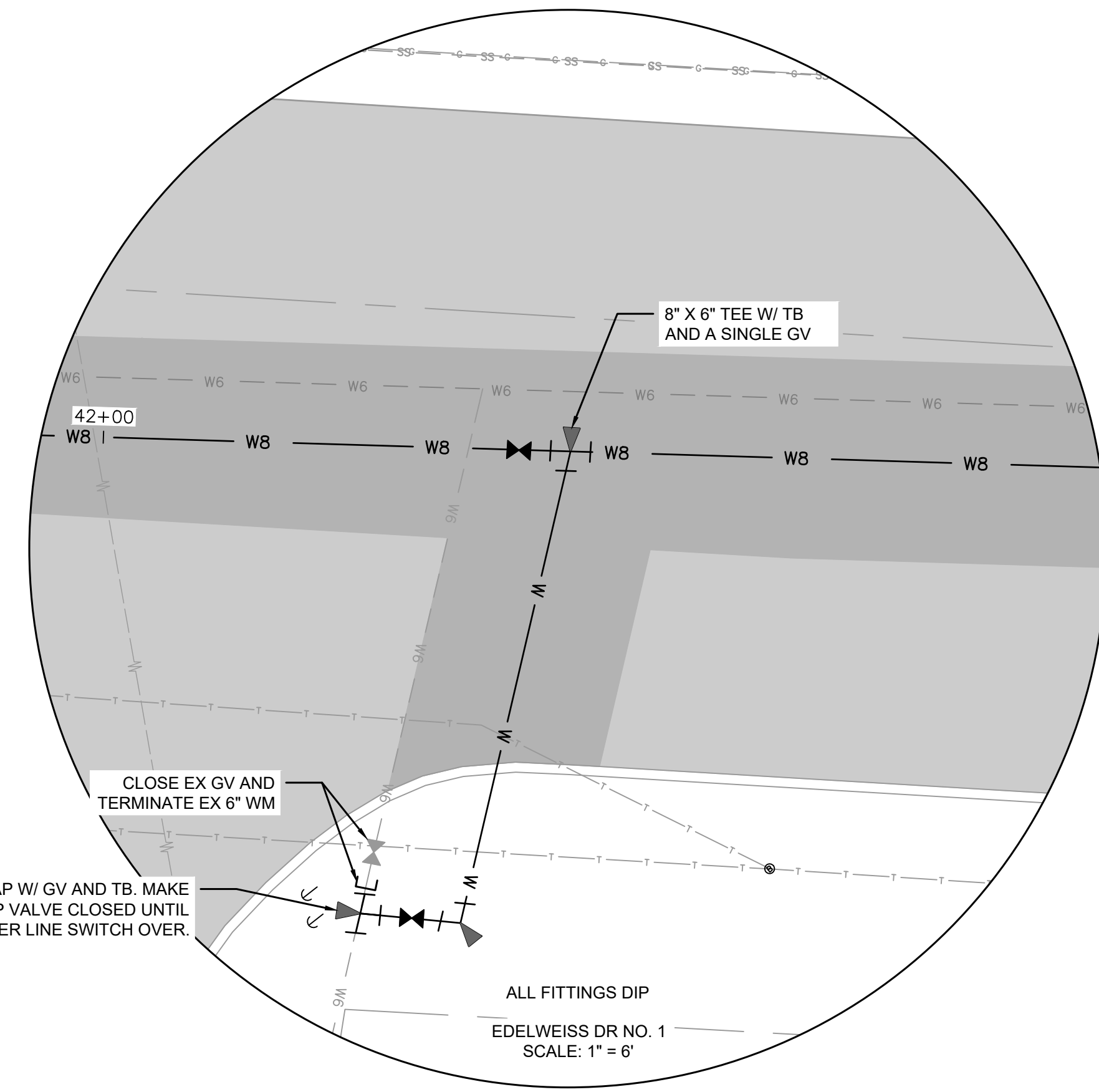
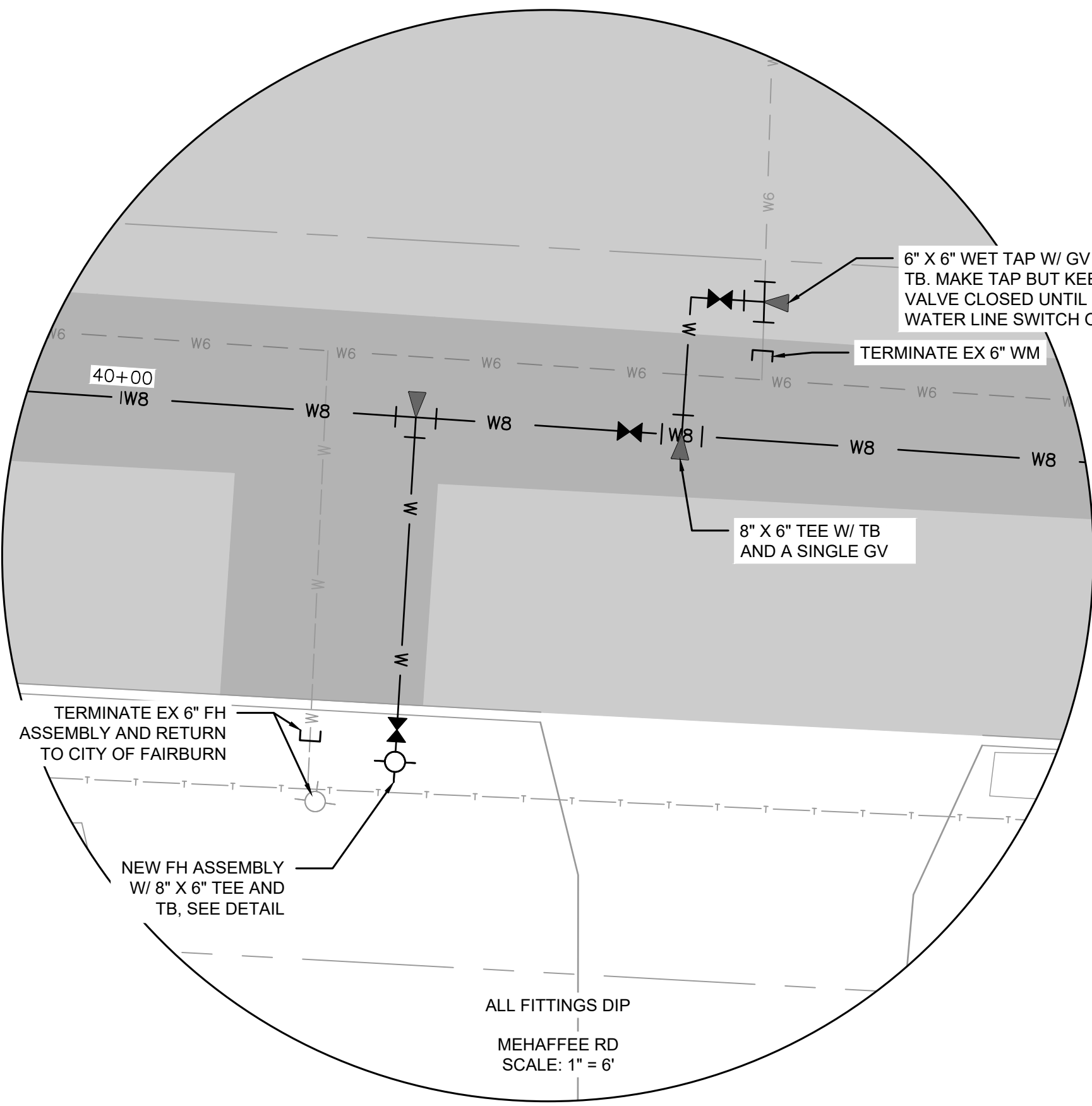
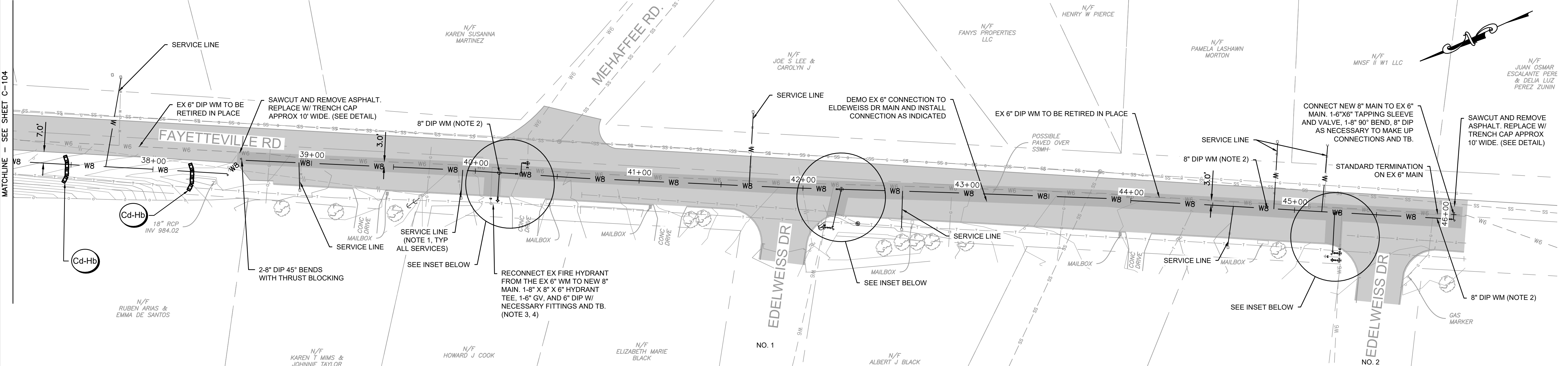

**PHASE I
STRUCTURAL PRACTICES**
THERE ARE NO STRUCTURAL PRACTICES FOR PHASE I

VEGETATIVE PRACTICES
THERE ARE NO VEGETATIVE PRACTICES FOR PHASE I

**PHASE II
STRUCTURAL PRACTICES**

CODE	PRACTICE	DETAIL	MAP SYMBOL	DESCRIPTION
Cd	CHECKDAM			A small temporary barrier or dam constructed across a swale, drainage ditch or area of concentrated flow.

**PHASE II
VEGETATIVE PRACTICES**

CODE	PRACTICE	DETAIL	MAP SYMBOL	DESCRIPTION
Du	DUST CONTROL ON DISTURBED AREAS			Controlling surface and air movement of dust on construction site, roadways and similar sites.
Ds1	DISTURBED AREA STABILIZATION (WITH MULCHING ONLY)			Establishing temporary protection for disturbed areas where seedlings may not have a suitable growing season to produce an erosion retarding cover.
Ds2	DISTURBED AREA STABILIZATION (WITH TEMP SEEDING)			Establishing a temporary vegetative cover with fast growing seedlings on disturbed areas.

**PHASE III
STRUCTURAL PRACTICES**
THERE ARE NO STRUCTURAL PRACTICES FOR PHASE III

VEGETATIVE PRACTICES

CODE	PRACTICE	DETAIL	MAP SYMBOL	DESCRIPTION
Ds3	DISTURBED AREA STABILIZATION (WITH PERM SEEDING)			Establishing a permanent vegetative cover such as trees, shrubs, vines, grasses, or legumes on disturbed areas.

INTEGRATED Science & Engineering
1038 SULLY ROAD, SUITE 200, NEWNAN, GEORGIA 30065
(770) 785-5522 | 106 (P) 678-5522 | 107
COA #: PEFC00623 Exp: 6/30/2022

REGISTERED PROFESSIONAL ENGINEER
CARY R. DILL

Rev.	Description	Date	App.
1	ADDENDUM NO. 1	12/17	

Date: 11/12/20
Drawn By: JMN
Check By: VIZ
Project #: 1009-1509
Design By: JMO
Review By: CRD
Scale: 1" = 30'
30' 15' 0' 30'

UTILITY PLANS FOR
FAYETTEVILLE ROAD
WATER MAIN IMPROVEMENTS
CITY OF FAIRBURN
PROJECT LOCATED IN LAND LOT 52 AND 53 OF THE 9TH DISTRICT, FULTON COUNTY, GEORGIA

SITE PLAN 5
STA. 37+15 - STA. 46+01

DRAWING NO.
C-105

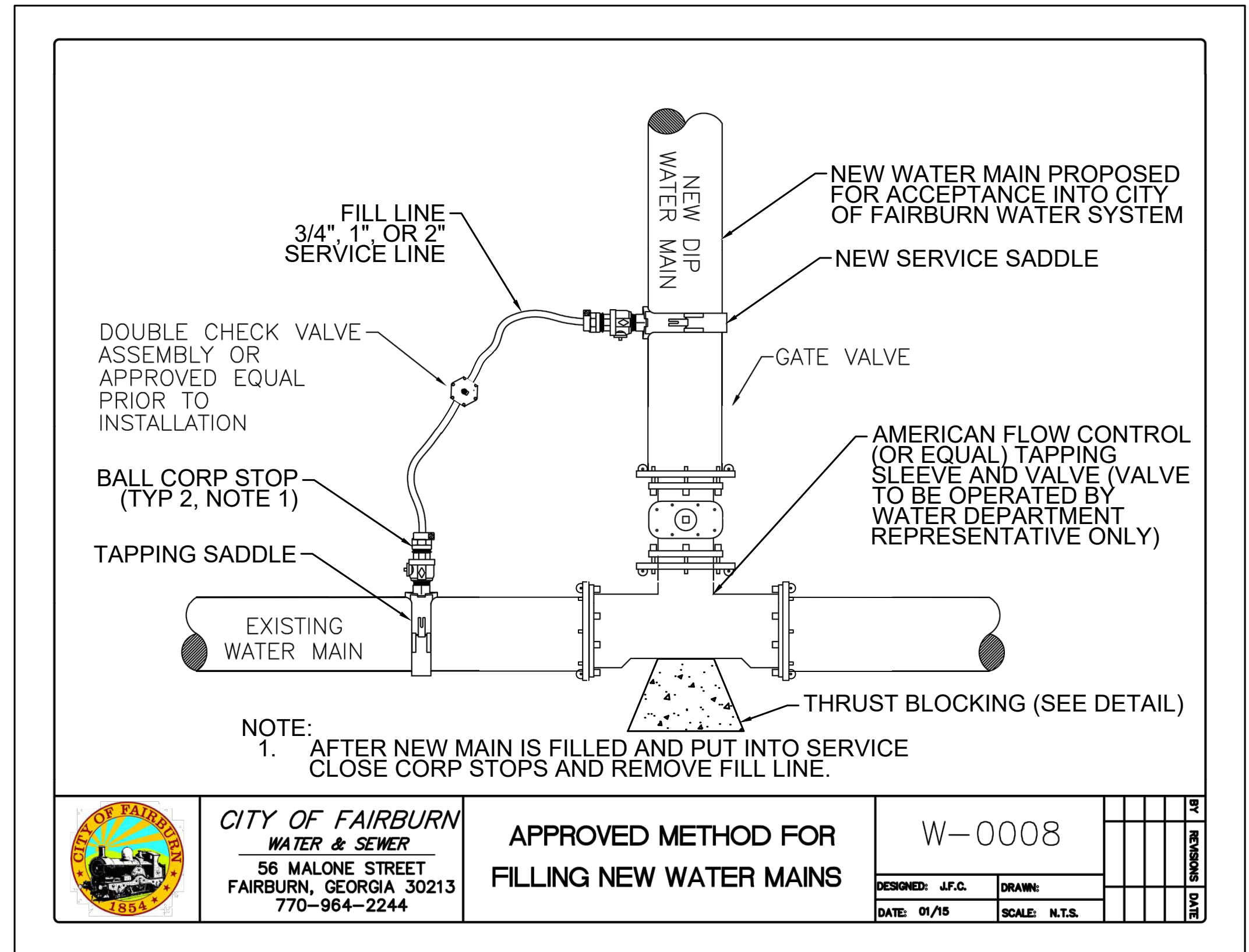
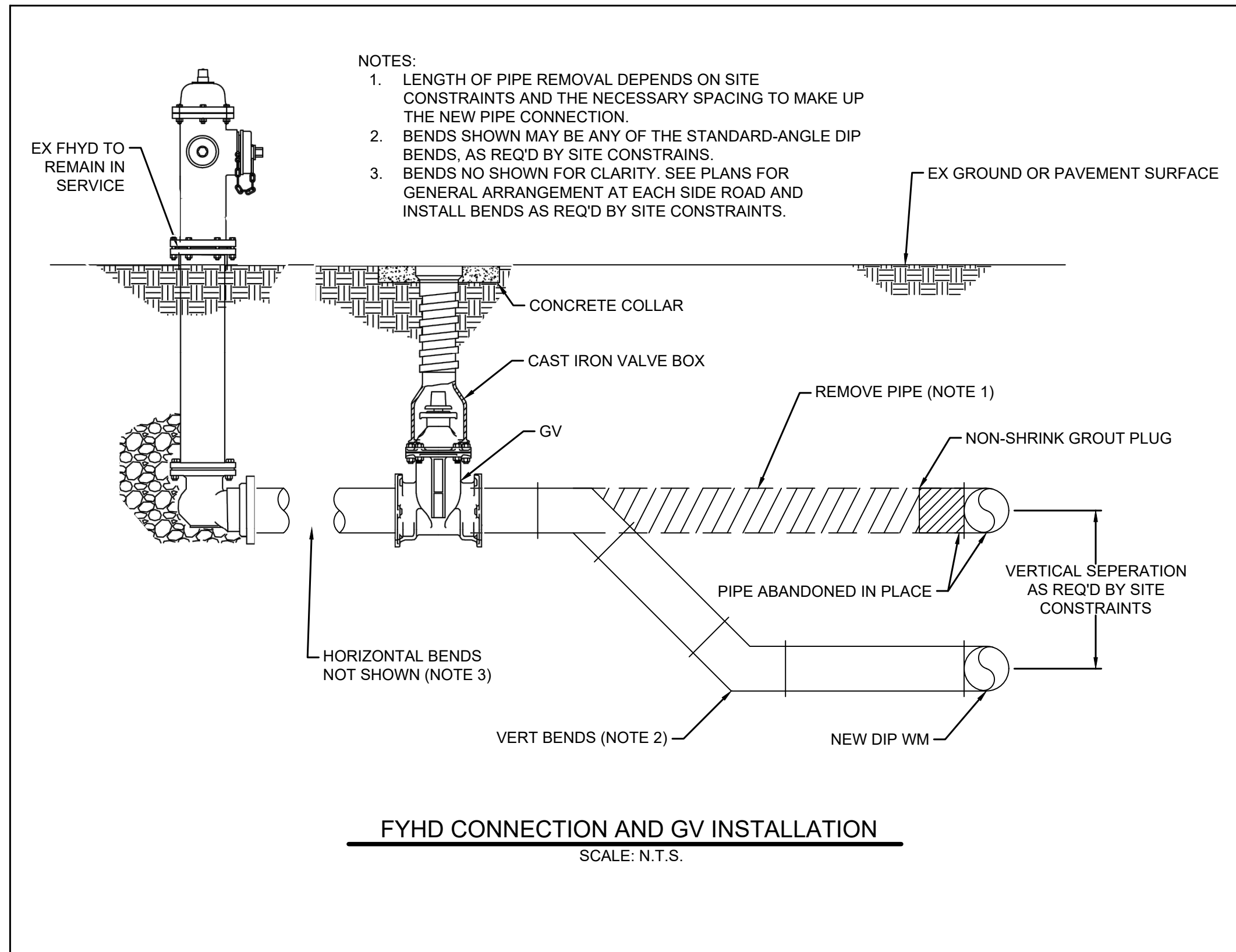
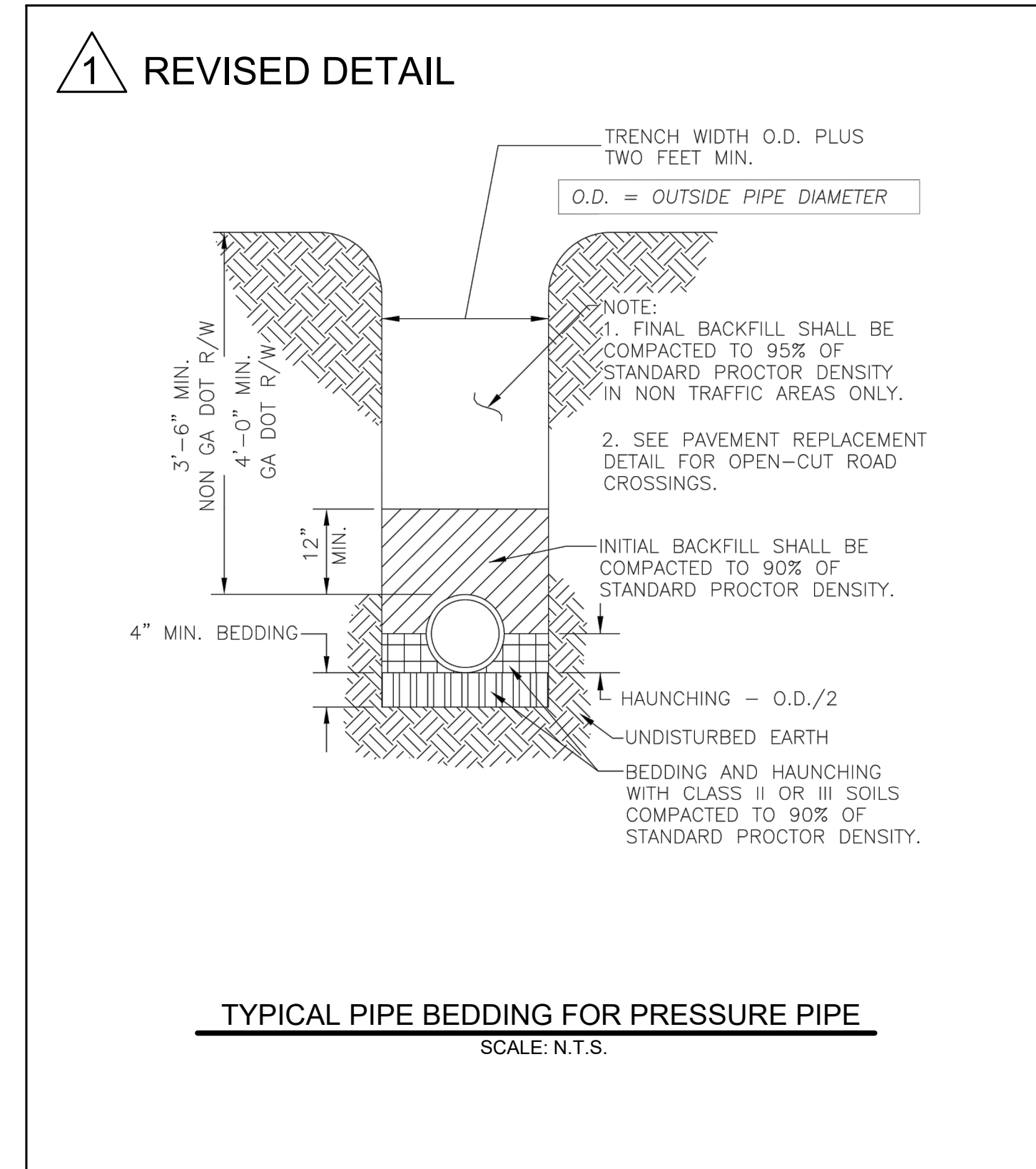
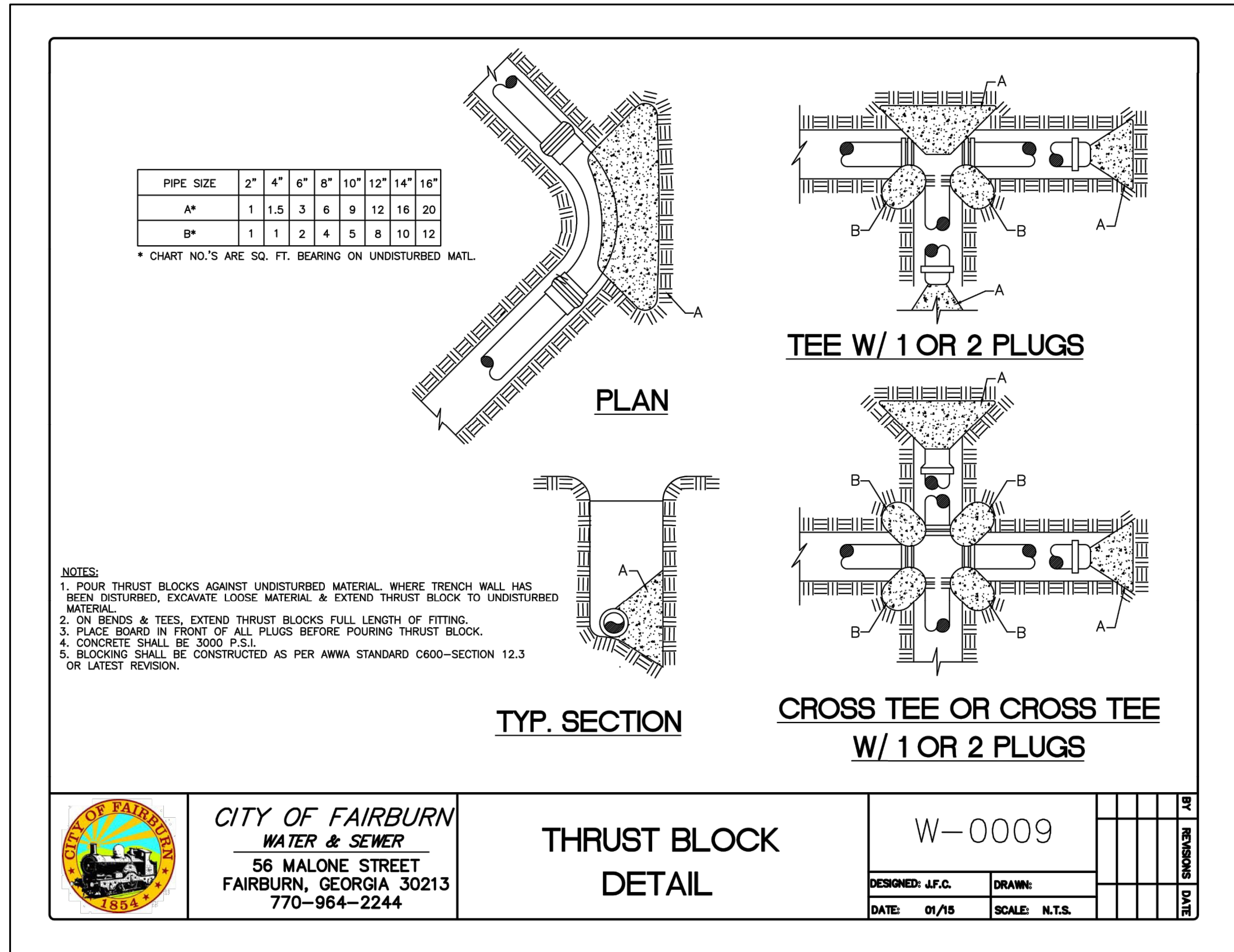

Rev.	Description	Date	App.
1	ADDENDUM NO. 1	12/17	

Date:	11/12/20	Drawn By:	J.M.V.	Check By:	V.T.Z.
Project #:	1009.1509	Design By:	J.M.V.	Review By:	CRD
Scale:	N.T.S.	Scale:	N.T.S.		

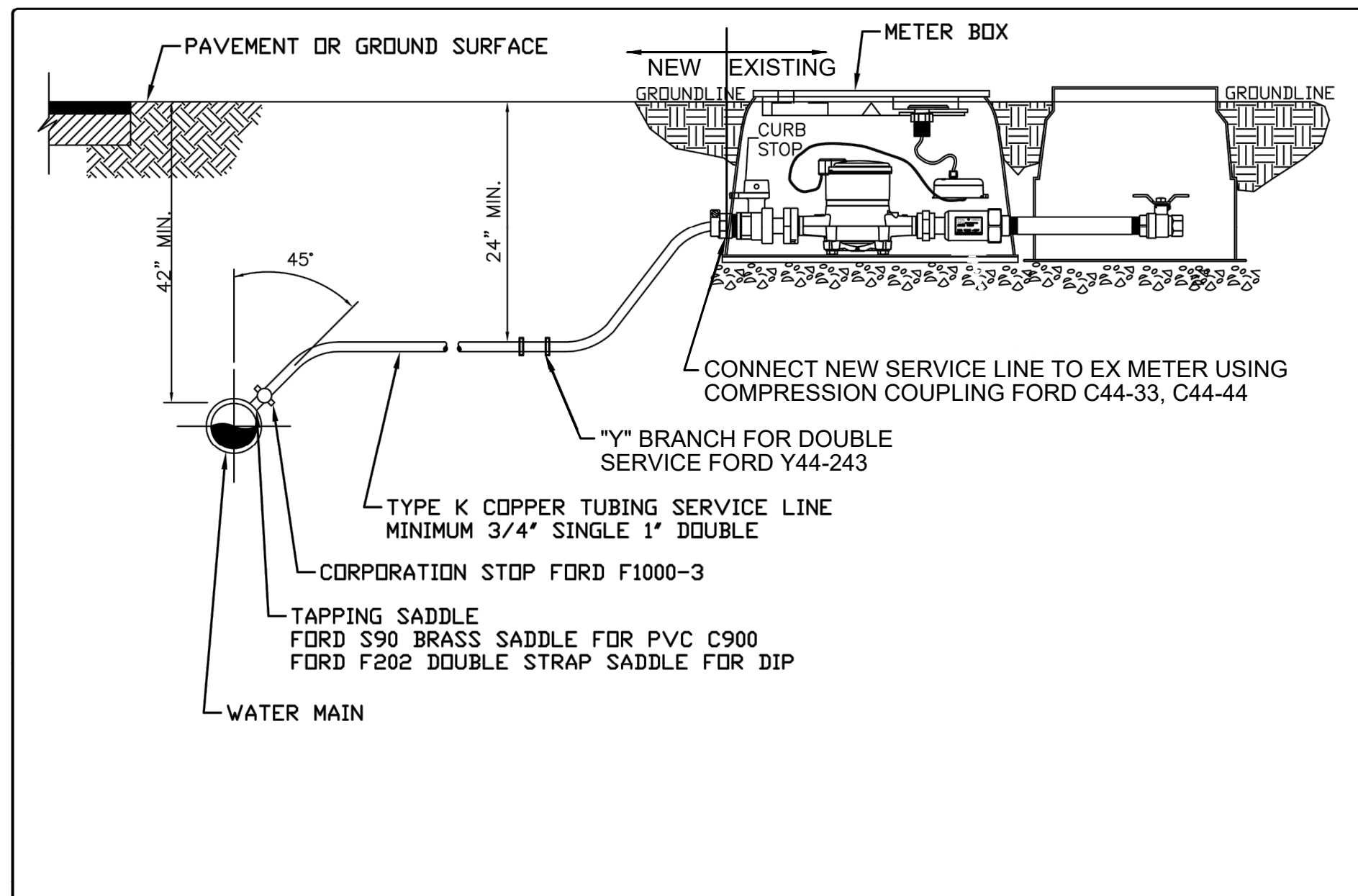

	CITY OF FAIRBURN WATER & SEWER 56 MALONE STREET FAIRBURN, GEORGIA 30213 770-964-2244	RESIDENTIAL SHORT SIDE SERVICE INSTALLATION	W-0020	DESIGNED: J.F.C.	DRAWN:	DATE: 01/15 SCALE: N.T.S.	SHEET NO. 1 OF 1
				DATE: 01/15	SCALE: N.T.S.		

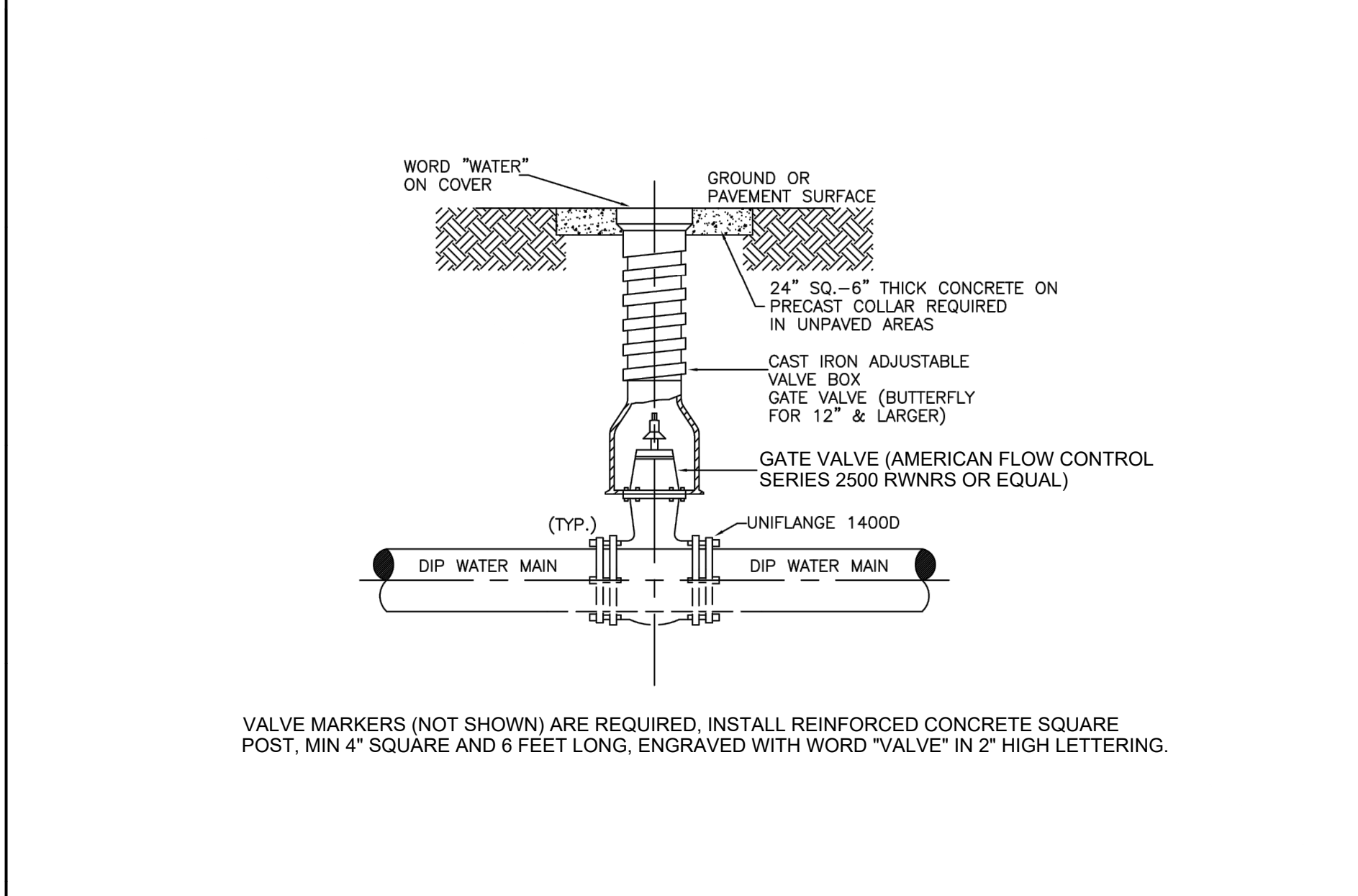

	CITY OF FAIRBURN WATER & SEWER 56 MALONE STREET FAIRBURN, GEORGIA 30213 770-964-2244	WATER LINE VALVE INSTALLATION	W-0023	DESIGNED: J.F.C.	DRAWN:	DATE: 01/15 SCALE: N.T.S.	SHEET NO. 1 OF 1
				DATE: 01/15	SCALE: N.T.S.		

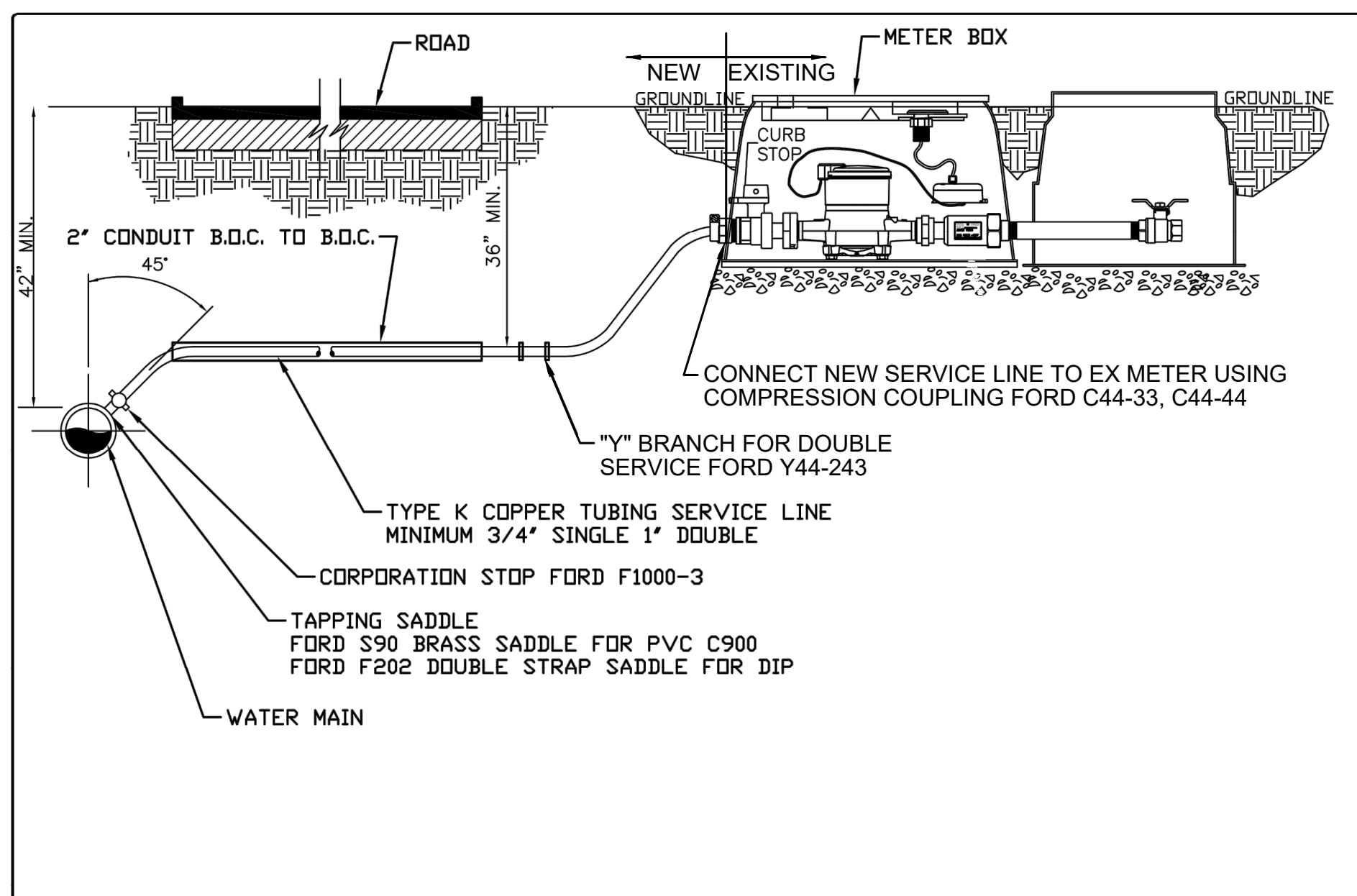

	CITY OF FAIRBURN WATER & SEWER 56 MALONE STREET FAIRBURN, GEORGIA 30213 770-964-2244	RESIDENTIAL LONG SIDE SERVICE INSTALLATION	W-0020A	DESIGNED: J.F.C.	DRAWN:	DATE: 01/15 SCALE: N.T.S.	SHEET NO. 1 OF 1
				DATE: 01/15	SCALE: N.T.S.		

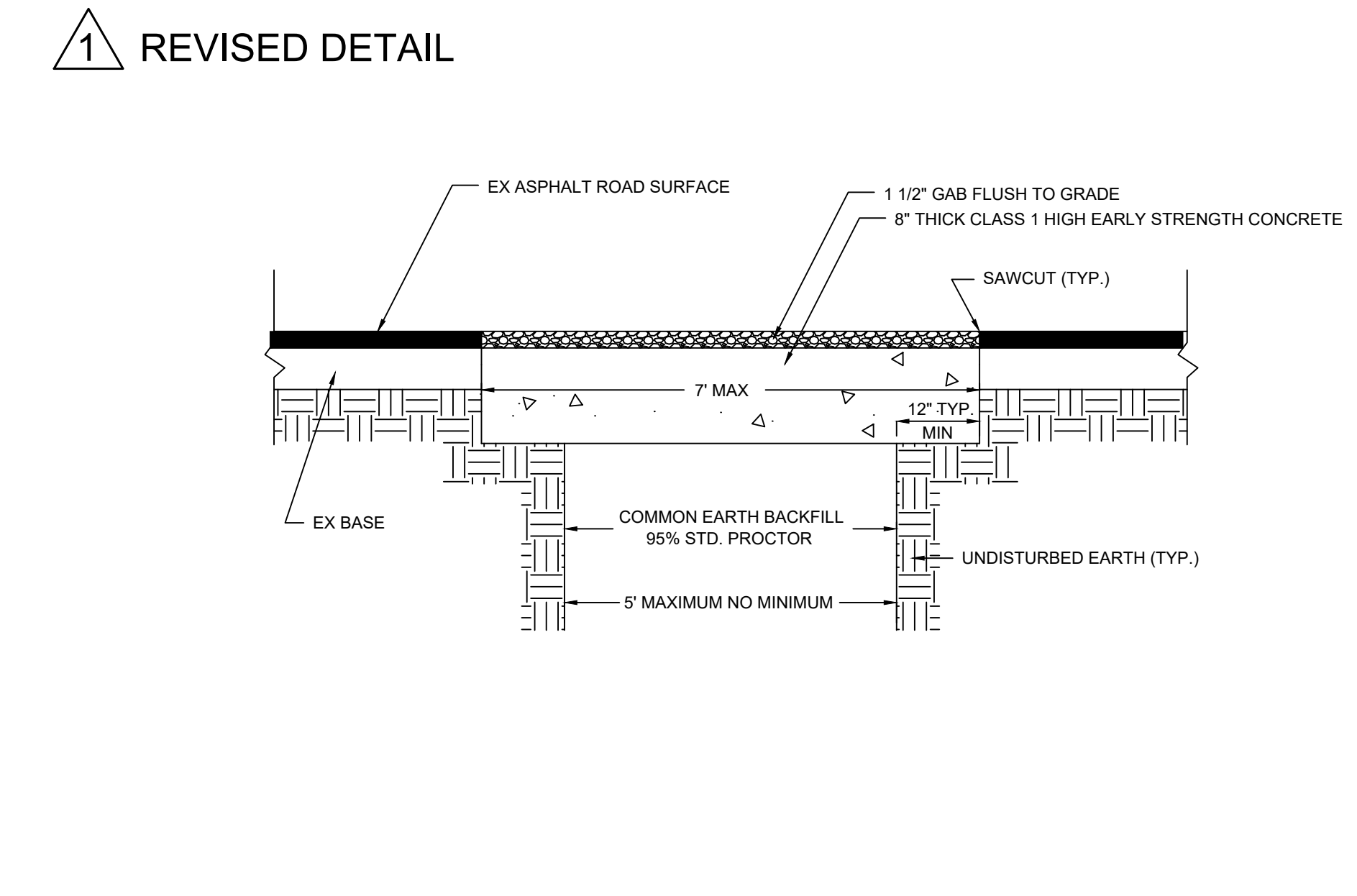

SAWCUT AND TRENCH CAP DETAIL
 SCALE: N.T.S.

Rev.	Description	Date
1	ADDENDUM NO. 1	12/17

Drawn By: JMN	Check By: VIZ
Design By: JMO	Review By: CRD
Project #: 1009-1509	Scale: N.T.S.

UTILITY PLANS FOR
FAYETTEVILLE ROAD
WATER MAIN IMPROVEMENTS
 CITY OF FAIRBURN
 PROJECT LOCATED IN LAND LOT 52 AND 53 OF THE 9F DISTRICT, FULTON COUNTY, GEORGIA

CONSTRUCTION DETAILS 3

DRAWING NO.
C-702